

ORDINANCE NO. 5470

AN ORDINANCE relating to the annexation of an area known as Kofal to Water District No. 111.

STATEMENT OF FACT:

1. A notice of intention proposing the annexation of an area known as Kofal to Water District No. 111 was filed with the County Council April 13, 1981.

2. Water District No. 111 has found the petition for annexation to be sufficient and has, by Resolution No. 161-2-81 concurred with the proposed annexation.

3. Water District 111 filed a Declaration of Non-significant Impact dated March 19, 1981, on the proposed annexation.

4. The County Council held a public hearing on the 18th day of May, 19 81, and has considered the criteria set forth in RCW 57.02.040.

BE IT ORDAINED BY THE COUNCIL OF KING COUNTY:

SECTION 1. The annexation by Water District 111 of the area known as Kofal and described in Section 3 herein is approved. King County Council Annexation Report on Kofal is attached and made a part of this ordinance.

SECTION 2. Completion of this annexation does not constitute county approval or disapproval of any other permits, certifications, or actions necessary to provide service to this annexation area.

SECTION 3. The area known as Kofal to be annexed is described as follows:

That portion of Sections 22 and 23, Township 22 North, Range 5 East, W.M., described as follows:

Beginning at the Northwest corner of said Section 23;

Thence Easterly along the North line of said Section 23 to its intersection with the East line of the West 1/2 of the West 1/2 of said Section 23;

Thence Southerly along said East line to its intersection with the South line of the North 300 feet of the SW 1/4 of the SW 1/4 of said Section 23;

1
2
3
4
5
6
7
8
9
10
11
12
13
14
15
16
17
18
19
20
21
22
23
24
25
26
27
28
29
30
31
32
33

1 Thence Westerly along said South line to its intersection with
2 the East line of the SE 1/4 of the SE 1/4 of said Section 22;

3 Thence Northerly along said East line to its intersection
4 with the North line of the said SE 1/4 of the SE 1/4;

5 Thence Westerly along said North line to its intersection
6 with the West line of the East 1/2 of the East 1/2 of said
7 Section 22;

8 Thence Northerly along said West line to its intersection with
9 the North line of the South 165 feet of the NW 1/4 of the NE 1/4
10 of said Section 22;

11 Thence Westerly along said North line to its intersection with
12 the West line of the East 660 feet of the said NW 1/4 of the
13 NE 1/4;

14 Thence Northerly along said West line to its intersection with the
15 South line of the North 496.69 feet of the said NW 1/4 of the
16 NE 1/4;

17 Thence Westerly along said South line to its intersection with
18 the East line of the West 66 feet of the said NW 1/4 of the NE 1/4;

19 Thence Northerly along said East line to its intersection with
20 the South line of the North 380 feet of the said NW 1/4 of the
21 NE 1/4;

22 Thence Westerly along said South line and the South line of the
23 North 380 feet of the NE 1/4 of the NW 1/4 of said Section 22
24 to its intersection with the West line of the East 309 feet of
25 the said NE 1/4 of the NW 1/4;

26 Thence Northerly along said West line to its intersection with
27 the North line of said Section 22;

28 Thence Easterly along said North line to the Northeast corner
29 of said Section 22 which is also the Northwest corner of said
30 Section 23 and the Point of Beginning.

31 INTRODUCED AND READ for the first time this 4th day of
32 May, 1981.

33 PASSED this 18th day of May, 1981.

KING COUNTY COUNCIL
KING COUNTY, WASHINGTON

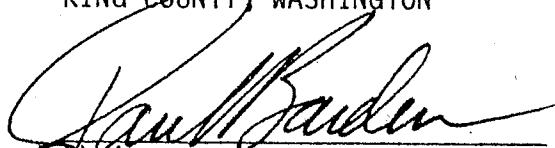
Chairman

ATTEST:

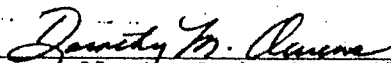
Clerk of the Council

APPROVED this 29th day of May, 1981.

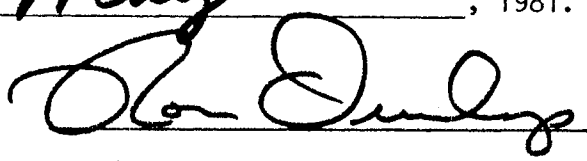

5410

DATE: May 14, 1981

Attachment
Proposed Ord. No. 81-263

KING COUNTY COUNCIL
ANNEXATION REPORT

King County Water District #111 Annexation of "Kofal"

Resol. 161-2-81

Files: BRB Temporary File #3-7

I. BUILDING AND LAND DEVELOPMENT DIVISION REPORT:

BALD Recommendation: Approve

This area is within the Water Service Area of the Soos Creek Communities Plan and is thus eligible for public water. While this district has experienced water shortages in the past, supplies are currently adequate and Water District #111, together with adjacent purveyors is making good progress in their search for additional water supplies.

BACKGROUND INFORMATION

Size of Parcel: 265 Acres

Community Planning Area: Soos Creek

Council District: #9

Existing Zoning and Land Use: The zoning in the area lying west of 148th Ave. S.E. varies from SR (9600) to SE according as slope of the terrain increases; SE zoning applies to the entire area lying east of 148th Ave. S.E. Scattered single-family development occurs over the area.

II. COUNCIL STAFF RECOMMENDATION:

Approve

81 MAY 18 A10: 36

KING COUNTY COUNCIL

RECEIVED

EXHIBIT E

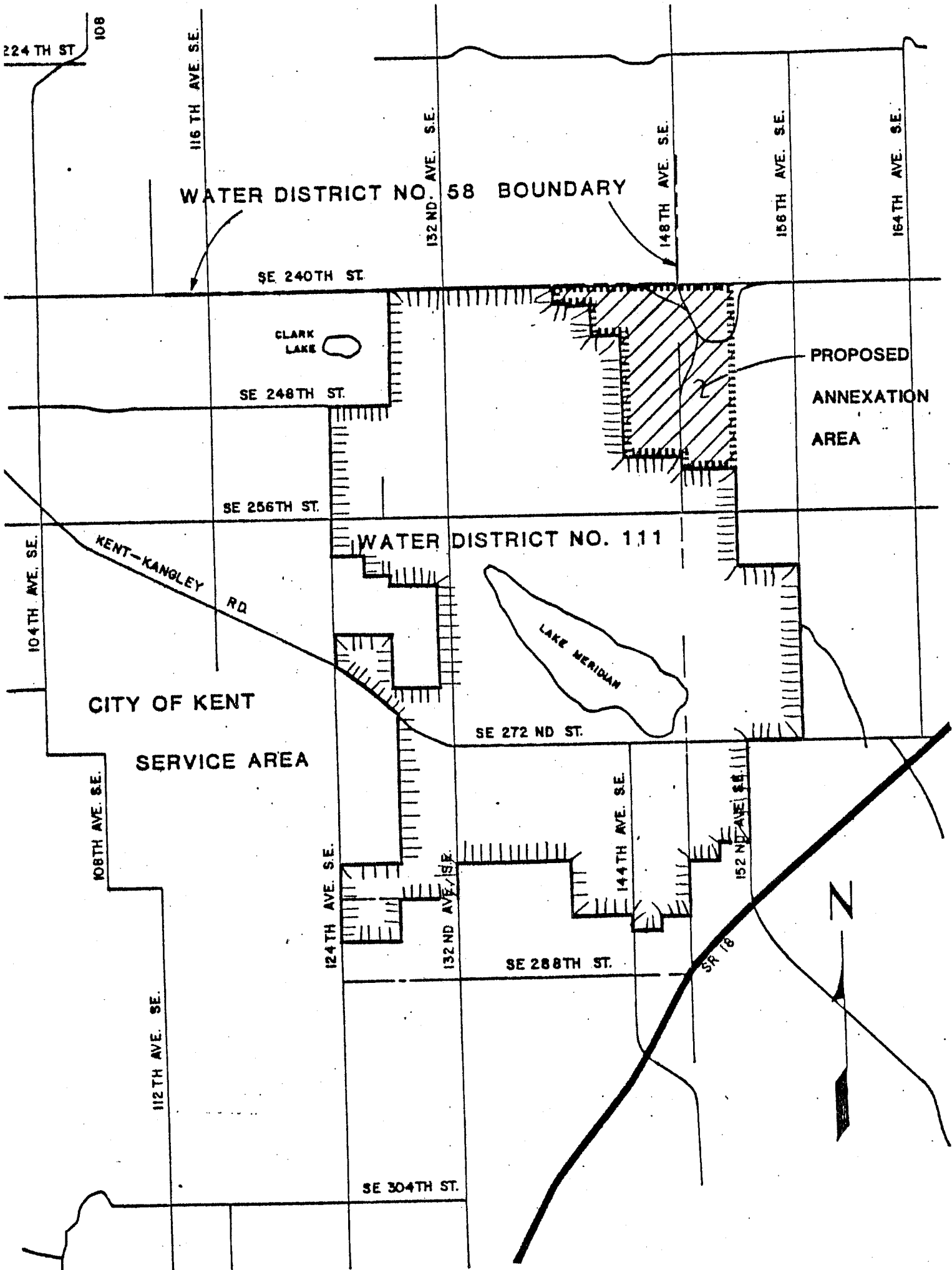

WATER DISTRICT NO. 111
VICINITY MAP

SCALE: 1 1/2 MILE